



HD SERIES

1.5 to 20kV, 0.6 to 3.0A, 35nS to Standard Recovery
Modular “Hi-Bel” Rectifier Assemblies



Features

- High Voltage, High Current Capability
- Can Be Easily Cascaded for Higher Voltage System Applications
- Molded Body with Integrated Heat Sink

Specifications¹

Part Number	V _{RRM} V	I _{FAVM} A	V _F V	I _R μA	I _{FSM} A	T _{RR} ² nS
Fast Recovery Hi-Bel 1.0 and 3.0 Amp Glass Passivated Rectifier Assembly Subseries						
HDD2.5	2500	2.30	4.0	0.5	100	250
HDC5	5000	1.20	7.0	0.5	100	250
HDD5	5000	1.50	7.0	0.5	100	250
HDC7.5	7500	0.90	11.0	0.5	100	250
HDD7.5	7500	1.00	11.0	0.5	100	250
HDC10	10000	0.80	13.0	0.5	50	150
HDC15	15000	0.60	22.0	0.5	50	150
Fast Recovery Hi-Bel 6.0 Amp Rectifier Assembly Subseries						
HDEF2.5	2500	3.00	3.6	5	200	350
HDEF5	5000	3.00	6.0	5	200	350
Standard Recovery Hi-Bel 1.0 and 3.0 Amp Glass Passivated Rectifier Assembly Subseries						
HDB2.5	2500	3.00	2.2	0.5	150	-
HDA5	5000	1.70	4.5	0.5	150	-
HDB5	5000	2.00	4.4	0.5	150	-
HDA7.5	7500	1.30	6.6	0.5	150	-
HDB7.5	7500	1.40	6.6	0.5	150	-
HDA10	10000	1.00	9.0	0.5	150	-
HDB10	10000	1.20	9.0	0.5	150	-
HDA15	15000	0.70	12.0	0.5	50	-
HDA20	20000	0.60	17.0	0.5	50	-
Standard Recovery Hi-Bel 6.0 Amp Rectifier Assembly Subseries						
HDE2.5	2500	4.00	3.0	5	400	-
HDE5	5000	4.00	5.0	5	400	-
Ultra Fast Recovery Hi-Bel 1.0 and 3.0 Amp Rectifier Assembly Subseries						
HDAUF5	5000	0.80	5.5	1	35	75
HDBUF5	5000	2.25	7.0	5	150	75
HDAUF7.5	7500	0.80	8.8	1	35	75
HDBUF7.5	7500	2.25	11.2	5	150	75
HDAUF10	10000	0.80	11.0	1	35	75
HDAUF15	15000	0.80	17.0	1	35	75
Ultra Fast Recovery Hi-Bel Rectifier Assembly Subseries						
HDT1	1000	2.50	2.0	10	250	50
HDT1.5	1500	2.00	3.0	10	250	50
HDU1.5	1500	1.00	8.0	1	50	35
HDV1.5	1500	1.40	8.0	5	125	35
HDU2	2000	0.90	10.0	1	50	35
HDV2	2000	1.30	10.0	5	125	35
HDU3	3000	0.70	15.0	1	50	35



HD SERIES

Part Number	V _{RRM} V	I _{FAVM} A	V _F V	I _R μA	I _{FSM} A	T _{RR} ² nS
Ultra Super Fast Recovery 1.0 and 2.0 Amp Rectifier Assembly Subseries						
HDAUSF5	5000	0.65	7.0	1	10	35
HDBUSF5	5000	1.75	10.0	5	60	40
HDAUSF7.5	7500	0.65	11.2	1	10	35
HDAUSF10	10000	0.65	14.0	5	10	35

Temperature °C	
Operating Temperature	-55 to 150
Storage Temperature	-55 to 150
Maximum Junction Temperature	150

¹125°C ambient temperature unless stated otherwise.

²A "-" indicates that the component is a standard recovery device and no T_{RR} data is taken.

Drawings

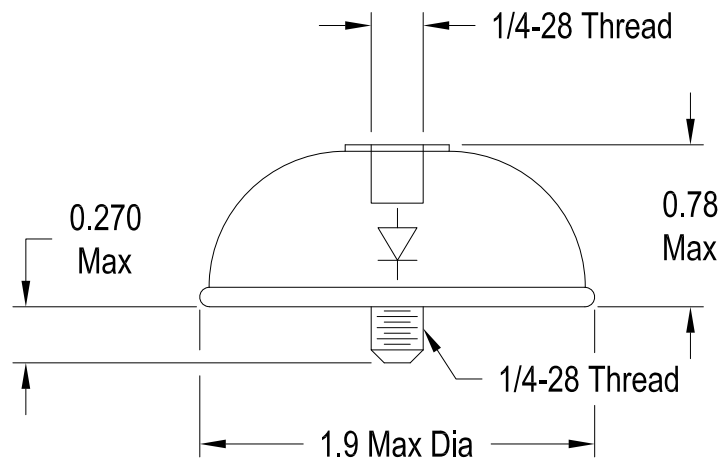

Dimensions in inches, tolerances ±0.020 except as noted

Specification Definitions

Specifications	Conditions	
V _{RRM}	Maximum Repetitive Reverse Voltage	-
I _{FAVM}	Maximum Average Forward Current	At T _C = 75°C
V _F	Maximum Forward Voltage Drop	At I _{FAVM}
I _R	Maximum Leakage Current	At V _{RRM}
I _{FSM}	Maximum Surge Current	At 8.3 mS, Single Half Sine
T _{RR}	Maximum Reverse Recovery Time	I _F = 0.5A; I _R = -1.0A; I _{RR} = -0.25A

Note: Specifications subject to change without notice. Photo is representation only.

