



HVFE SERIES

2.5 to 5kV, 600mA, 35nS
Axial Lead Flat Pack Rectifiers



Features

- Epoxy Molded Body

Specifications¹

Part Number	V _{RRM} V	I _{FAVM} mA	V _F V	I _R μA	I _{FSM} A	T _{RR} nS	L in.
HVFE2500	2500	600	13	1	50	35	2.75
HVFE5000	5000	600	24	1	50	35	4.25

Temperature °C	
Storage Temperature	-55 to 150
Operating Temperature	-55 to 150

¹125°C ambient temperature unless stated otherwise.

Drawings

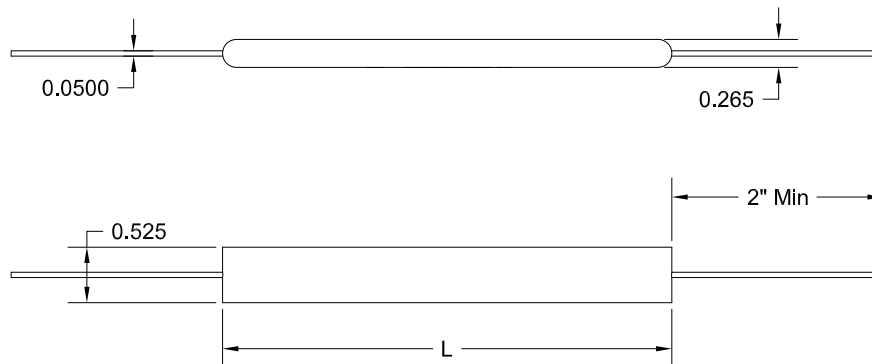

Dimensions in inches, tolerances ±0.020 except as noted

Specification Definitions

Specifications	Conditions
V _{RRM} Maximum Repetitive Reverse Voltage	-
I _{FAVM} Maximum Average Forward Current	At T _A = 55°C
V _F Maximum Forward Voltage Drop	At I _{FAVM}
I _R Maximum Leakage Current	At V _{RRM}
I _{FSM} Maximum Surge Current	At 8.3 mS, Single Half Sine
T _{RR} Maximum Reverse Recovery Time	I _F = 0.25A; I _R = -0.5A; I _{RR} = -0.125A

Note: Specifications subject to change without notice. Photo is representation only.

