



HVUSF SERIES

2.5 to 20kV, 500mA, 35nS
Axial Lead Flat Pack Rectifiers



Features

- Epoxy Molded Body

Specifications¹

Part Number	V _{RRM} V	I _{FAVM} mA	V _F V	I _R μA	I _{FSM} A	T _{RR} nS	L in.
HVUSF2500	2500	500	4.2	1	10	35	1.125
HVUSF5000	5000	500	7.0	1	10	35	2.000
HVUSF7500	7500	500	11.2	1	10	35	2.750
HVUSF10000	10000	500	14.0	1	10	35	3.500
HVUSF12500	12500	500	18.2	1	10	35	4.250
HVUSF15000	15000	500	21.0	1	10	35	4.250
HVUSF20000	20000	500	28.0	1	10	35	4.250

Temperature °C	
Storage Temperature	-55 to 150
Operating Temperature	-55 to 150

¹125°C ambient temperature unless stated otherwise.

Drawings

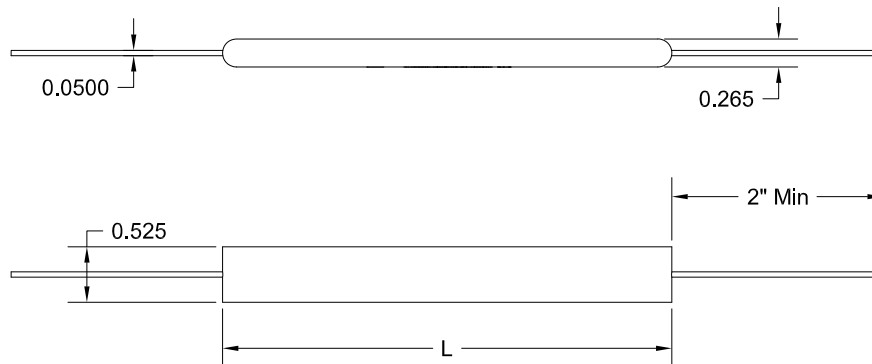

Dimensions in inches, tolerances ±0.020 except as noted

Specification Definitions

Specifications	Conditions
V _{RRM} Maximum Repetitive Reverse Voltage	-
I _{FAVM} Maximum Average Forward Current	At T _A = 55°C
V _F Maximum Forward Voltage Drop	At I _{FAVM}
I _R Maximum Leakage Current	At V _{RRM}
I _{FSM} Maximum Surge Current	At 8.3 mS, Single Half Sine
T _{RR} Maximum Reverse Recovery Time	I _F = 250mA; I _R = -500mA; I _{RR} = -125mA

Note: Specifications subject to change without notice. Photo is representation only.

