



HV SERIES

5 to 30kV, 600mA, Standard Recovery
Axial Lead Flat Pack Rectifiers



Features

- Epoxy Molded Body

Specifications¹

Part Number	V _{RRM} V	I _{FAVM} mA	V _F V	I _R μA	I _{FSM} A	L in.
HV5000	5000	600	4.5	0.5	50	1.125
HV7500	7500	600	7.2	0.5	50	1.625
HV10000	10000	600	9.0	0.5	50	2.000
HV15000	15000	600	14.0	0.5	50	2.750
HV20000	20000	600	18.0	0.5	50	3.500
HV25000	25000	600	22.0	0.5	50	4.250
HV30000	30000	600	28.0	0.5	50	4.250

Temperature °C	
Storage Temperature	-55 to 150
Operating Temperature	-55 to 150

¹25°C ambient temperature unless stated otherwise.

Drawings

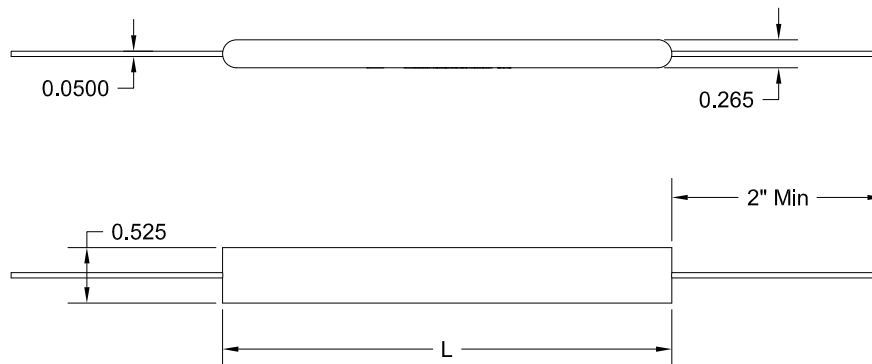

Dimensions in inches, tolerances ±0.020 except as noted

Specification Definitions

Specifications	Conditions
V _{RRM} Maximum Repetitive Reverse Voltage	-
I _{FAVM} Maximum Average Forward Current	At T _A = 55°C
V _F Maximum Forward Voltage Drop	At I _{FAVM}
I _R Maximum Leakage Current	At V _{RRM}
I _{FSM} Maximum Surge Current	At 8.3 mS, Single Half Sine

Note: Specifications subject to change without notice. Photo is representation only.

