

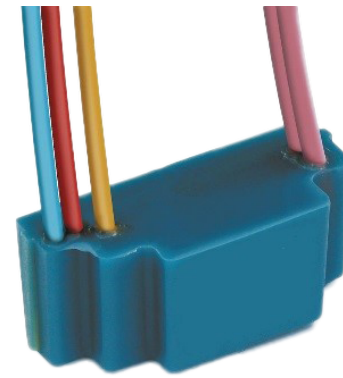

2132 SERIES

8 to 12kV, 0.04 to 0.06W
High Voltage Power Supplies



Features

- 8kVDC or 12kVDC Output Voltage Standard
- Other Output Voltages Available
- Compact and Cost Effective
- Reliable Solid-State Design
- Maintenance Free
- Completely Encapsulated
- Automatic Over-Current Shutdown and Recovery
- UL/cUL Recognized Component; CE Mark (LVD and RoHS)

Applications

- Ionizers
- Tabletop Air Cleaners
- Laser Start-Up Circuits
- EOS/ESD Anti-Static Equipment

Specifications

Conditions		Value		Units
Input				
Voltage	Nominal	120		VAC
Current	Nominal	15		mA
Power	Max Load	2		W
Output				
Voltage	Primary Output	+8	+12	kVDC
Power	Nominal Input, Max V _{OUT}	0.04	0.06	W
Current	Nominal Input, Max V _{OUT} , Unregulated	1 to 5		μA
Static Load Regulation	No Load to Full Load, Primary Max V _{OUT}	<30%	<40%	VDC
Ripple	Full Load, Max V _{OUT}	<5%		Vp-p
Stability	30-minute warmup, per 8h/per day	<0.5%		VDC
Environmental				
Operating Temperature	Case Temperature, Full Load, Max V _{OUT}	0 to +60		°C
Temperature Coefficient	Over the Specified Temperature	0.08		%/°C
Storage Temperature	Non-Operating, Case Temperature	-40 to +85		°C
Humidity	All Conditions, Standard Package	0 to 95% Non-Condensing		-
Altitude	All Conditions, Standard Package	0 to 10000		ft

Safe Operation Notes:

- This power supply should never be mounted directly to a metal surface.

Part Number	Input Voltage VAC	Output Voltage kV	Polarity	Input Frequency Hz
ACN2132L8	120	-8	Negative	50/60
ACP2132L8	120	8	Positive	50/60
ACN2132L12	120	-12	Negative	50/60
ACP2132L12	120	12	Positive	50/60

Note: Output voltages shown are minimum DC @ 1μA. Output drops approximately 1kV for each additional μA of load current.

Mechanical Drawings and Curves

NOTES:

1. ALL WIRE LENGTHS ARE ± 1/2".
2. ALL STRIP LENGTHS ARE ± 1/8".
3. PACKAGE MUST NOT BE MOUNTED TO A CONDUCTIVE SURFACE.

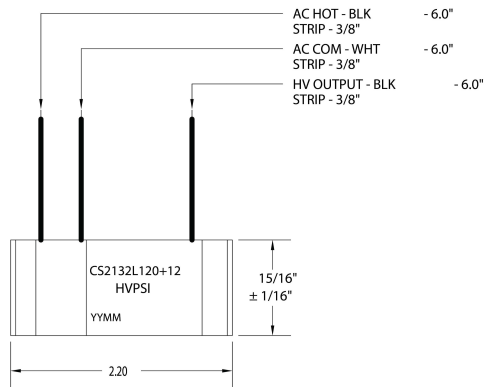
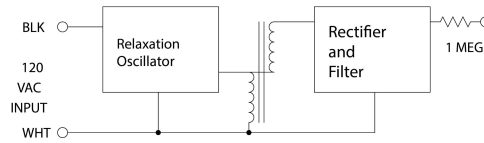
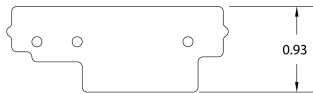

HV OUTPUT:
+12 TO +15 KV DC
AT 1 uA.

CRITICAL MATERIALS:

- ENCAPSULANT - FILLED EPOXY
UL 94V0 RATED.
- PRIMARY WIRES - 22 GA, PVC, 600 V,
UL STYLE 1015, 105 C.
- HV WIRE - 22 GA, IRRAD, PVC, 15 KV,
UL STYLE 3239, 105 C.
- OUTPUT ISOLATION - THROUGH 1 MEGOHM
RESISTOR.
- 21830 THERMIFILM UL APPROVED WHITE
POLYESTER LABEL 0.625" X 0.875".

Mechanical Specifications	
Encapsulant	Filled Epoxy (UL94V-0 Rated)
Mounting	Cable-Ties, Epoxy, RTV or Silicon <i>If glued, it is recommended the glue to be applied to two surfaces.</i>
Primary Wires	22AWG PVC, 600V, UL Style 1015, 105°C 2 Wire or 3 Wire Available
High Voltage Wires	22AWG, 15kVDC, UL Style 3239, 105°C
Operating Temperature	0°C to +60°C
Storage Temperature	-40°C to +85°C

Additional Options Available:

- Input ground wire
- Control Wires (Requires a 2W potentiometer, not supplied)
- "Power-On" indicating light
- Input to Output Isolation

Custom voltages and housings are also available. Contact the factory for additional information.

Certifications and Compliances

